

CONFERENCE CENTER FLOORPLAN

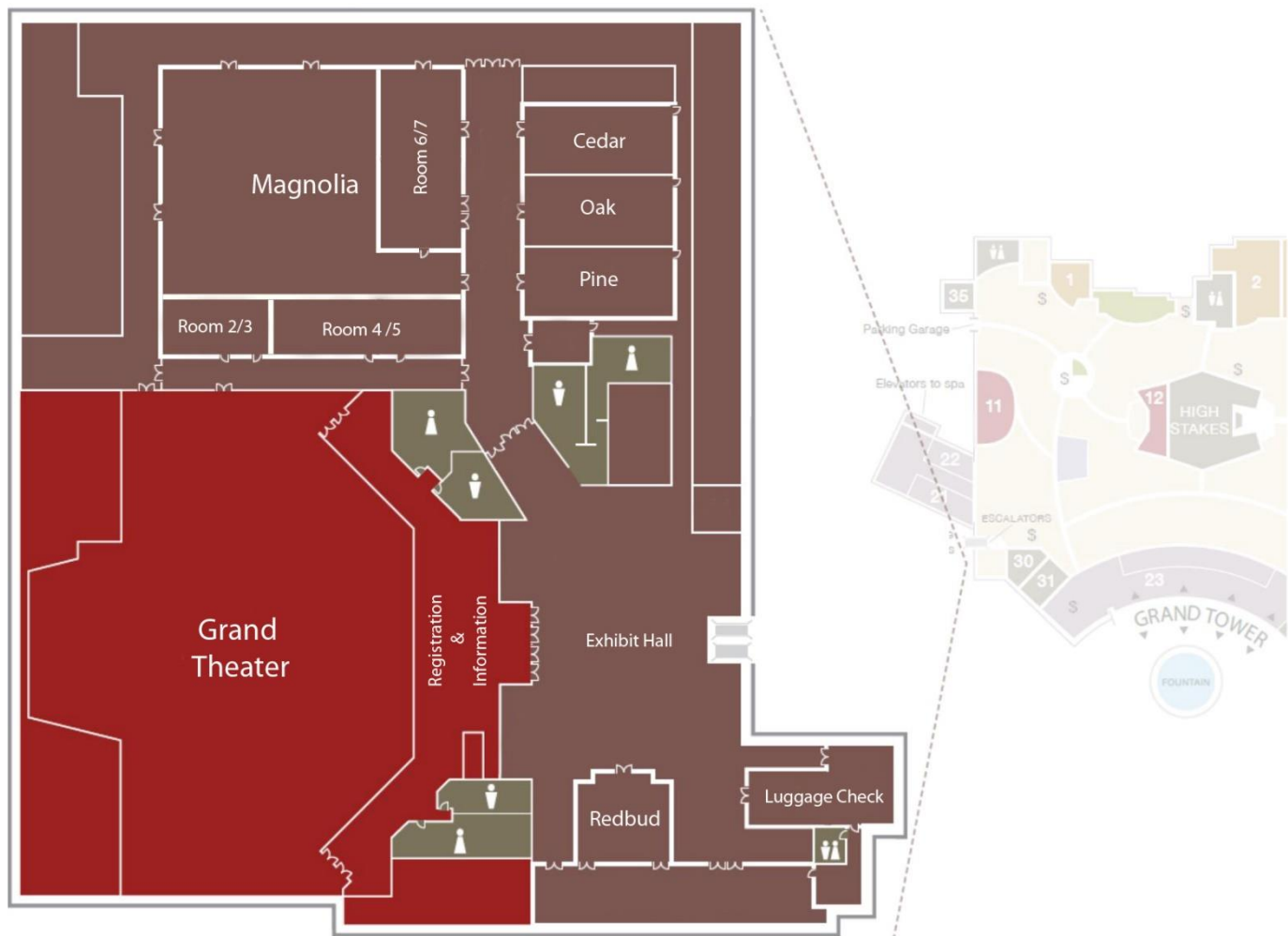

Vendor booth assignments are numbered below and are subject to change.

- | | |
|---|--|
| 1 Piraino Consulting, Inc. | 23 School Specialty |
| 2 Creative Educational Strategies & Services - Fiddle Focus | 24 Sporttime, Abilitations, SAX and STEAM - School Specialty |
| 3 KISS Institute for Practical Robotics | 25 Childcraft - School Specialty |
| 4 Scholastic Book Fairs | 26 Dan St. Romain Educational Consulting, LLC |
| 5 Dexter Educational Play | 27 The Tardy Bell |
| 6 FOSS Science - School Specialty | 28 Video Reality |
| 7 Oklahoma Mesonet | 29 Claire Lynn Designs |
| 8 Doodle and Peck Publishing | 30 George Couros |
| 9 Pop Around The Corner | |
| 10 Haddock Education Technology | |
| 11 Scholastic Education | |
| 12 Kinder Extravaganza | |
| 13 Oklahoma History Center | |
| 14 Renaissance Learning | |
| 15 You CAN Do the Rubik's Cube | |
| 16 Frog Street Press | |
| 17 Oklahoma Career Guide - Galazy for Elementary | |
| 18 Teacher Tops | |
| 19 Lakeshore Learning Materials | |
| 20 Lightspeed Technologies | |
| 21 Oklahoma Foundation for Excellence | |
| 22 Debbie Clement/Rainbows Within Reach | |

Grand Theatre

